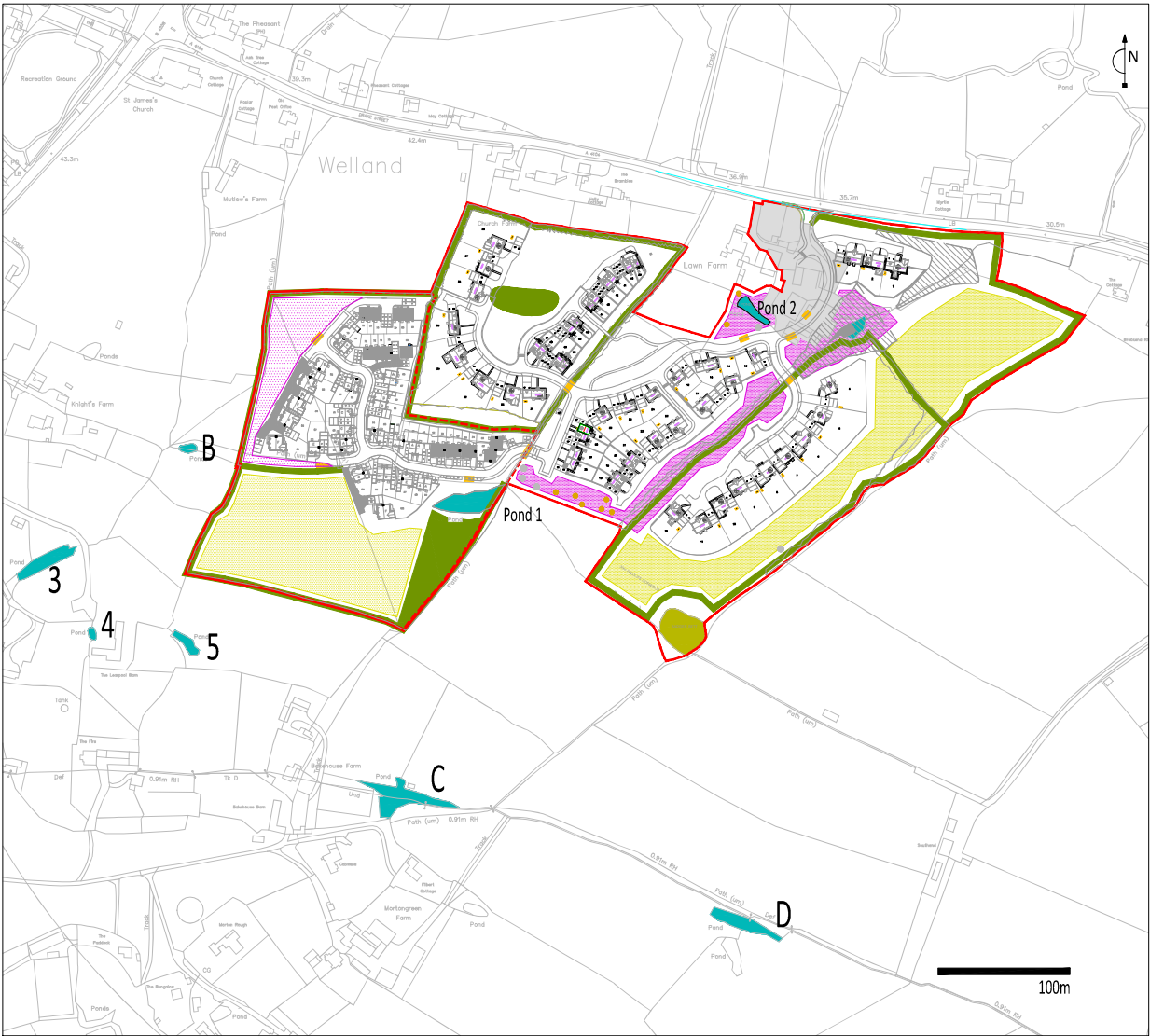

Fig. E3.1

drawing title: Map to show all habitat creation, restoration and enhancement measures
client: Bovis Homes
project: Drake Street, Welland
dwg no.: d373/004c
scale: as shown
date: 12/08/15 kd/rc



KEY

- Tussock grassland: Light grazing or mowing no more than two to three times a year for an average sward height of 150mm
- Wildflower grassland: One mowing a year between July and September, arisings removed
- Hardstanding and buildings
- Woodland
- Hedge
- Waterbody: Vegetation management in and around waterbody and de-silting. Monitoring for fish, rubbish and pollution, with remediation as required.
- Site Boundary
- Extended boundary (additional 3.9ha)
- Hibernacula
- Refuges
- Indicative locations of drop kerbs, required where road bisects hedge and close to Ponds, in all other areas they should be placed approx. every 25m where there is otherwise a barrier to habitat.

n.b. All gully pots to be offset from kerbs and gully pots on main roads to be modified with GCN escape ramps.

Fig. F1

drawing title: Map to show final layout of development and mitigation measures

client: Bovis Homes

project: Drake Street, Welland

dwg no.: d373/009c

scale: as shown

date: 12/08/15 kd/rc

Granville Studio, Waterlane, Oakridge, Stroud GL6 7PJ

1. 01452 77 10 10
 e. info@diversity.biz
 www.diversity.biz

