

Lewisham Local Plan

Examination Hearing Sessions

Response to further information request for Action 150: Map showing Network Rail land interest in at the Bermondsey Dive Under site (LNA SA 08 site allocation)

Prepared to inform the Local Plan Examination

- The orange hatch areas are demised to Arch Co on a 150-year lease.
- The green hatch area (marked 1) retains the operational use - NR freehold.
- The green hatch area (marked 2) is also demised to Arch Co.
- The remaining green hatch areas are operational (mainly forming embankment, track access points etc) – NR freehold.

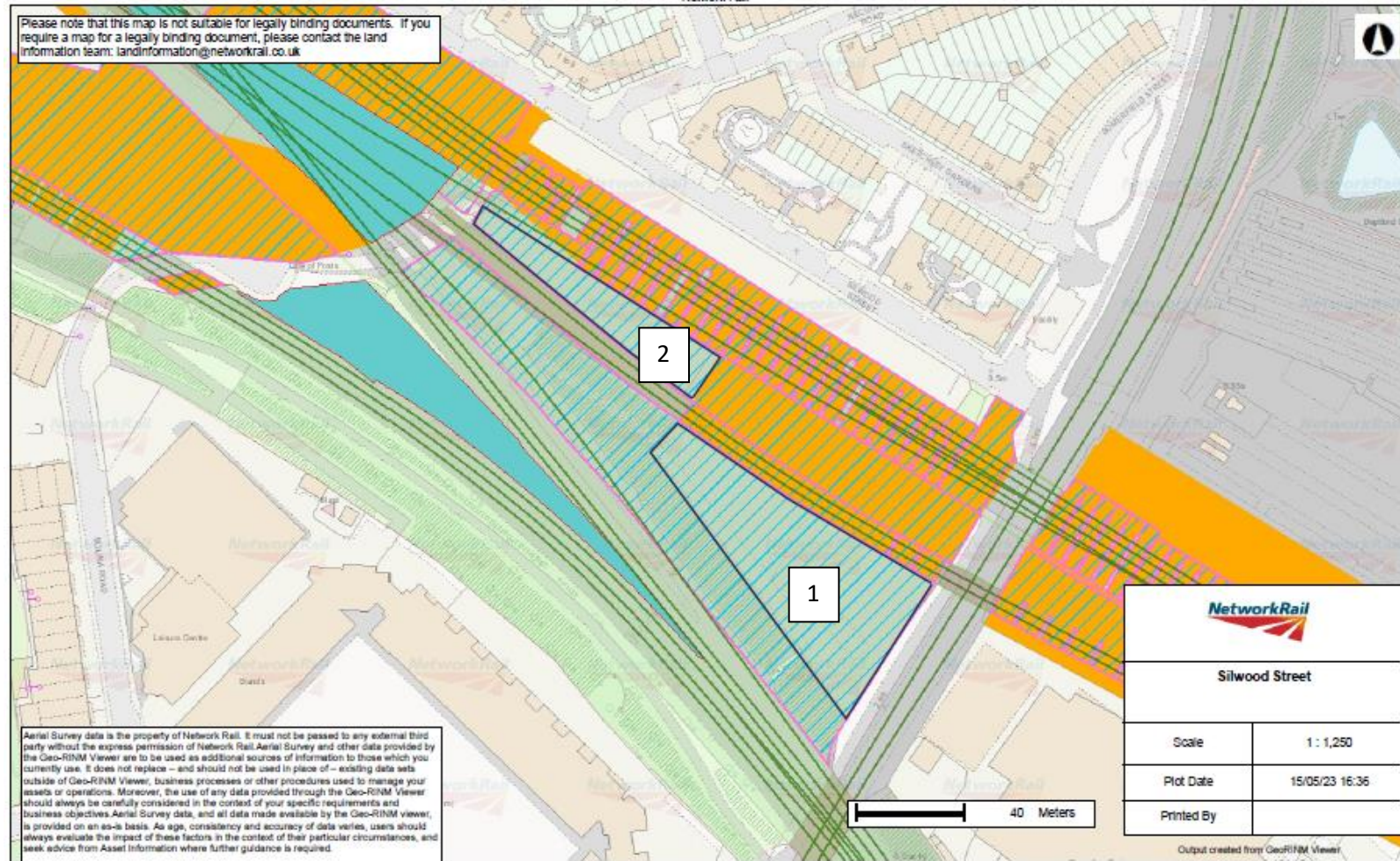

COPYRIGHTS
 This product includes map data licensed from Ordnance Survey. © Crown copyright and database rights 2021 Ordnance Survey 0100040692.
 © Local Government Information House Limited copyright and database rights 2021 Ordnance Survey 0100040692.
 Contains British Geological Survey materials © NERC 2021
 The Five Mile Line diagrams are copyright of Waterman Civils and must not be passed to any third party.